



### Mandrel Rod Stop Assembly

For use with Model HB632 bender.

The Mandrel Rod Stop Assembly, when bolted to the end of a table opposite of the bender, keeps the mandrel rod in alignment with the tube when mandrel bending.

**Part Name** Mandrel Rod Stop Assembly (for bender Model HB632)..... **Part No.** 631141



Fig. S36 — Mandrel Rod Stop Assembly /632

### Mandrel Rod Stop Assembly

For use with Exactol 412/424 Model benders.

**Part Name** Mandrel Rod Stop Assembly ..... **Part No.** 550571

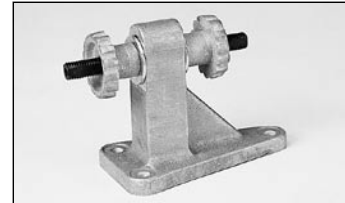

Fig. S37 — Mandrel Rod Stop Assembly 412/424

**Part Name** Stop Assembly Adapter/Riser for 424..... **Part No.** 631154

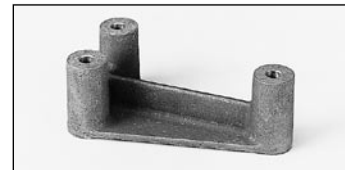

Fig. S38 — Stop Assembly Adapter/Riser

### Universal Side Angle Indicator

For use with Model HB632 bender.

Accurately determines angle between tube bends in different planes. Keeps out of plane angles accurate, when making repeated bends. Large, easy-to-read vernier dial. Maximum 3/4" O.D. tube can be used if the tube must be extended through the indicator. Maximum 1 1/2" O.D. tube can be used if end of tube is held in clamp jaw.

**Part No.** 520520



Fig. S39 — Universal Side Angle Indicator

Dimensions and pressures for reference only, subject to change.